



Is Architecture Still a Sought-After Profession in Pakistan?

Evaluating the Demand and Relevance of Architecture as a Profession in Pakistan



Report by
Institute of Architects Pakistan (IAP)

Ar. Fawad Suhail Abbasi, President IAP

Ar. Dr. Samra Mohsin Khan, Vice President IAP.



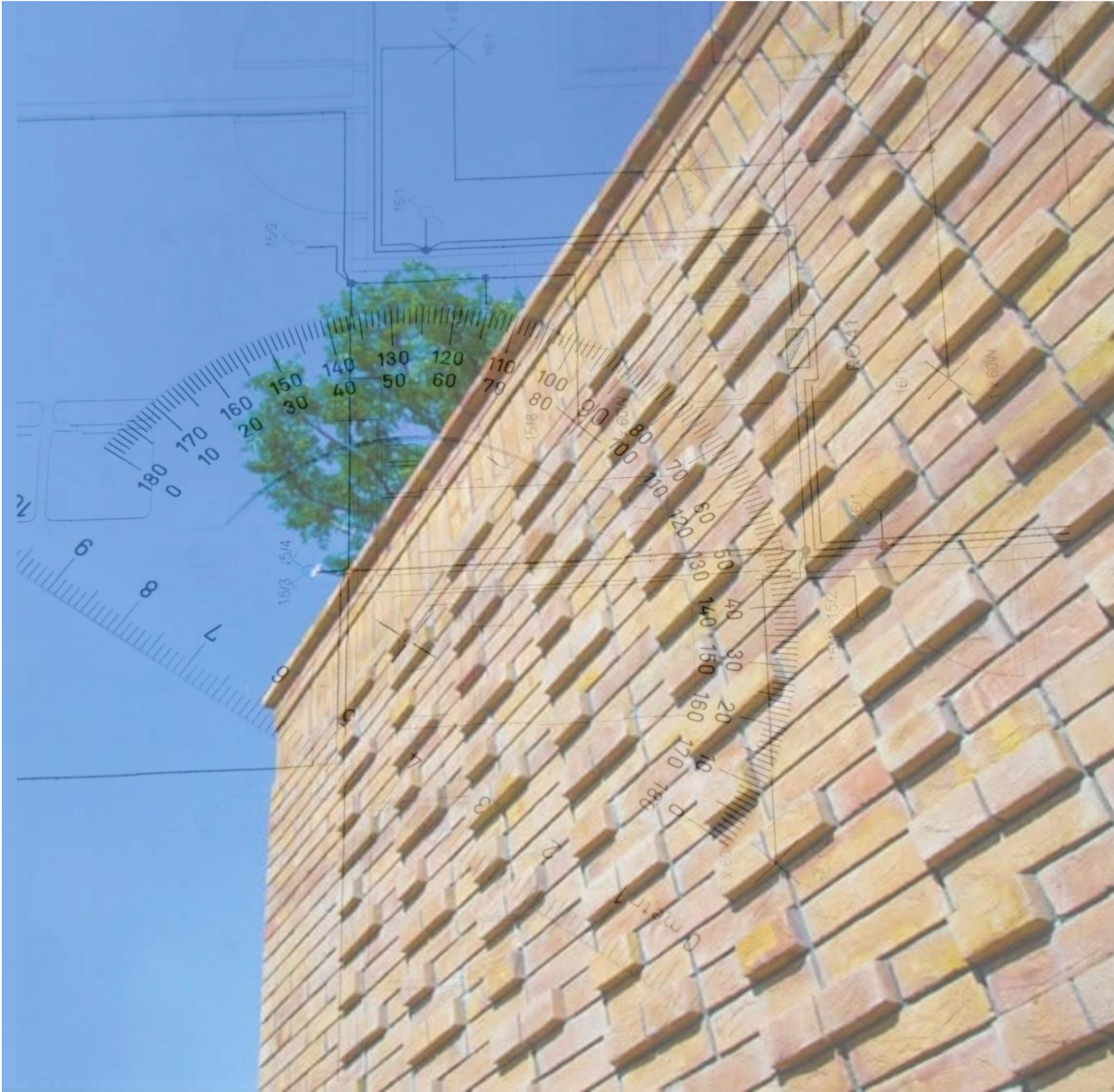

Presentation Agenda

- Evolution of Architectural Practice in Pakistan
- Current Status: Between Aspiration and Ambiguity
- Challenges: Structural, Economic, and Cultural
- Future Opportunities: Reclaiming Relevance and Impact
- Career Pathways: Navigating the Landscape
- Conclusion and recommendations: Reimagining Architecture as a Sought-After Profession in Pakistan

Historical Overview of Architecture in Pakistan



Evolution of Architectural Practice in Pakistan



Indus Valley Civilization

The Indus Valley Civilization—among the world’s earliest—demonstrated sophisticated planning, standardized construction, and civic infrastructure.

Islamic & Mughal Architecture

Islamic design influences are evident in Pakistan’s Mughal architecture through domes, arches, and decorative motifs.

Colonial Influence

Colonial era introduced European architectural elements that merged with local styles in Pakistan's buildings.

Post-Independence Modernism

Modern architectural practice in Pakistan integrates contemporary trends with respect to tradition and history.

Significant Architectural Landmarks

Badshahi Mosque

The Badshahi Mosque is a prime example of Mughal architecture, featuring grand domes, Mughal arches, red sandstone and richly embellished interiors.

Faisal Mosque

Faisal Mosque is known for its modern design that takes inspiration from Islamic style and turns it into a contemporary architectural monument.

Mohatta Palace

Mohatta Palace reflects colonial-era architecture with amalgamation of the classical European architecture with Mughal architecture.

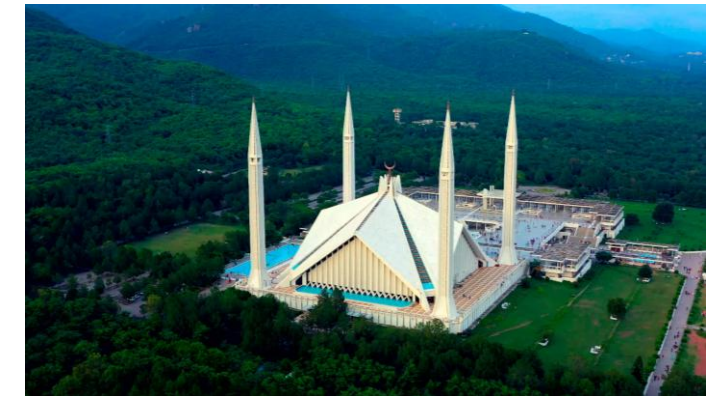

Current Status: Between Aspiration and Ambiguity



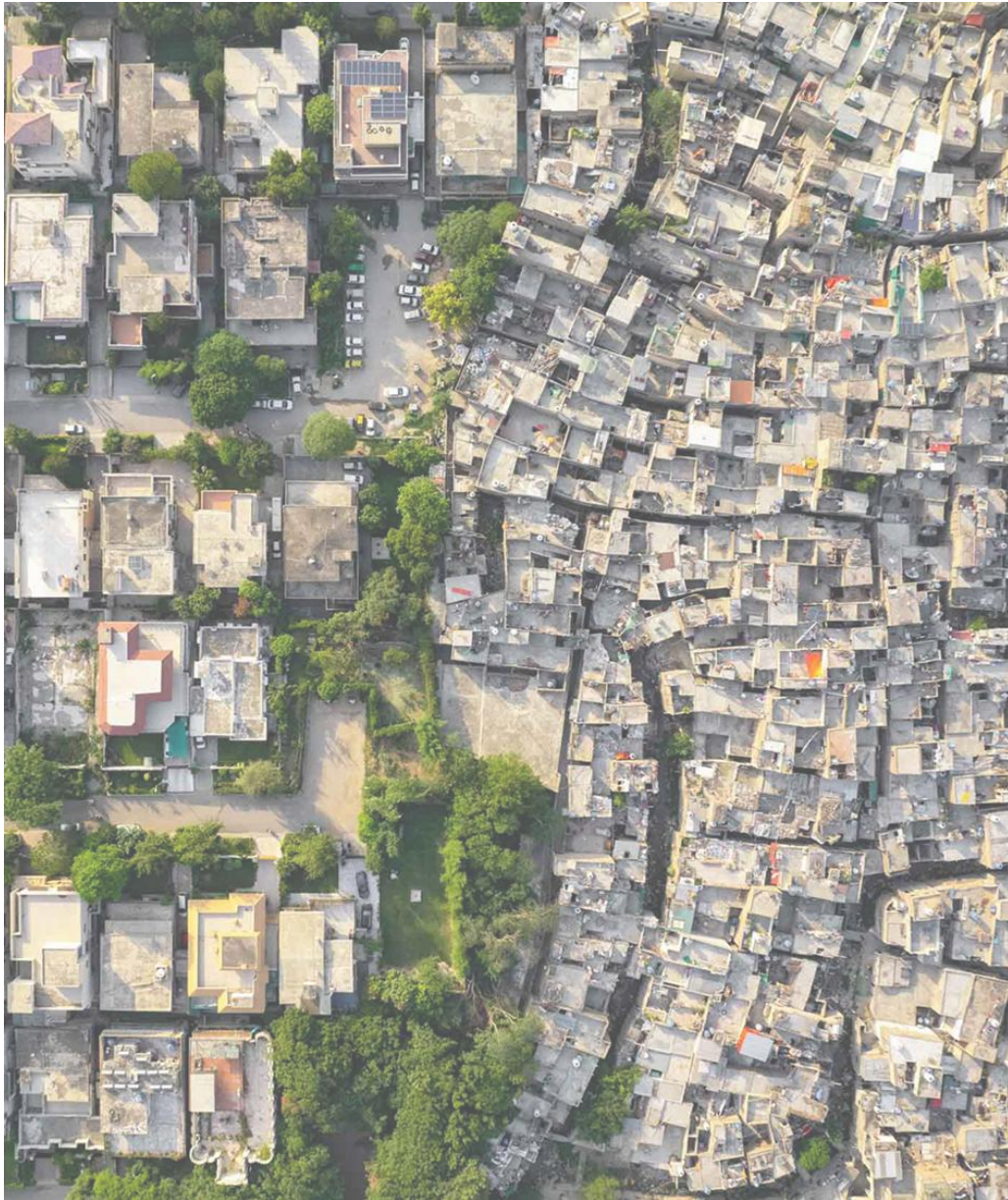

Education and Research: Cultivating Architectural Thought



Professional Bodies: PCATP & IAP



Professional Saturation



Urban Growth vs. Design Quality

An aerial photograph of a densely packed informal settlement, likely a slum. The structures are small, makeshift, and built with various materials, including brick, concrete, and corrugated metal. The buildings are closely packed together, with narrow, unpaved paths between them. In the foreground, several people are visible, some sitting on the ground or near a makeshift structure. The overall scene depicts a crowded and informal living environment. A white horizontal bar is positioned above the text.

Challenges: Structural, Economic, and Cultural

Educational Disconnects: Theory-Practice Gap

Curricula in most institutions also lag behind global standards, with minimal integration of digital tools such as Building Information Modeling (BIM), parametric design, or GIS-based analysis.

Economic Volatility

Construction slowdowns, inflation, and political instability directly impact architectural commissions and job security.

ARCHI Confidence METER



Why did you did that??
Didn't you learn ANYTHING
in college?



College toppers are SO academic.
We're the real deal...



LEEWARDISTS™
www.leewardists.com









Fee Structures & Professional Recognition

Architects are often expected to negotiate or justify their worth, with fee discussions reduced to cost-cutting rather than quality assurance.



Gender and Inclusion Barriers

While women consistently excel in academic environments—often leading design studios, winning awards, and producing innovative work—their transition into professional practice is marked by exclusion and constraint.



 AR. UZMA NOREEN ZAIN	 AR. DR. SAMRA MOINSIN KHAN	 AR. SEEMA ANDLEEB NASIR	 AR. RABIA TANVEER ALAM
 AR. WAQHA REHAN	 AR. ANILA JAHANZAIB	 AR. NIMRA GAZI	 AR. SANA HUSSAIN SABRI

CELEBRATING WOMEN IN ARCHITECTURE

Regulatory Complexity and Governance Gaps

limited integration of architects into policymaking or public sector frameworks

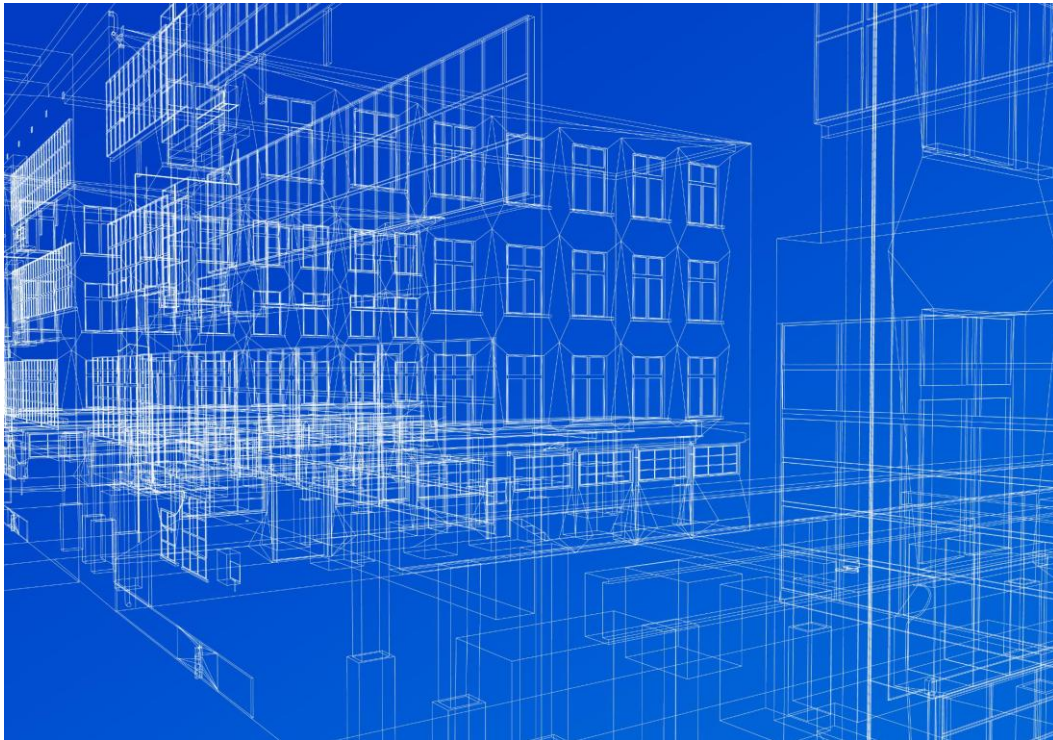

Lengthy approval processes and under-resourced regulatory bodies add a “time tax” to projects.

Architects often need multiple licenses to work across jurisdictions, even with national registration



Future Opportunities: Reclaiming Relevance and Impact



Sustainability & Climate Resilience

Sustainability and climate resilience are rapidly becoming central to architectural practice in Pakistan, reshaping both the profession's responsibilities and its relevance.

Heritage-Led Development

Heritage-led development is emerging as a dynamic and multidimensional avenue for architectural practice in Pakistan, offering both cultural resonance and professional relevance.

Education and Research Expansion

Expanding architectural education, advancing research in vernacular traditions, and fostering collaborations with global institutions are essential to elevating both the knowledge base and professional practice in Pakistan.

Technology and Innovation

Emerging technologies in Pakistani architecture are reshaping how buildings are designed, constructed, and experienced—ushering in a new era of efficiency, sustainability, and cultural responsiveness.



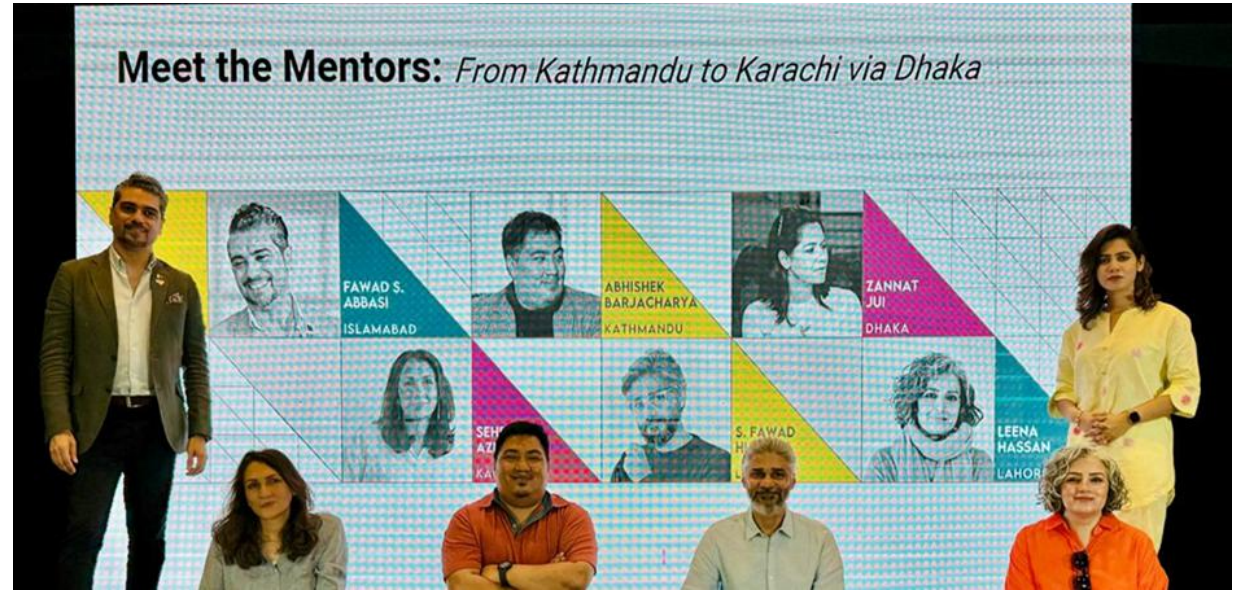

Career Pathways: Navigating the Landscape



Pathway	Description	Desirability Factors
Private Practice	Design firms, consultancies, freelance work	Creative freedom, but income instability
Public Sector	Government departments, planning authorities	Job security, limited design autonomy
Academia & Research	Teaching, publishing, heritage documentation	Intellectual fulfillment, modest pay
Allied Fields	Interior design, visualization, urban branding	Marketable skills, broader client base
International Opportunities	Remote work, global firms, postgraduate study	Exposure and growth, but competitive entry

Conclusion and recommendations: Reimagining Architecture as a Sought-After Profession in Pakistan

For Policymakers

- Integrate Architects into Urban Governance
- Standardize Fee Structures and Licensing
- Invest in Heritage and Regeneration Projects
- Support Innovation and Research

For Educators and Institutions

- Revise Curricula for Relevance
- Strengthen Industry-Academia Linkages
- Promote Gender Equity and Inclusion
- Encourage Critical Regionalism

Architecture in Pakistan is not merely a profession—it is a platform for shaping cities, communities, and collective memory. By rethinking its structures and narratives, we can ensure it remains a compelling, respected, and future-ready career for generations to come.